

# GS-410-54MH-M10

## MONO PERC HALF-CELL BLACK MODULE

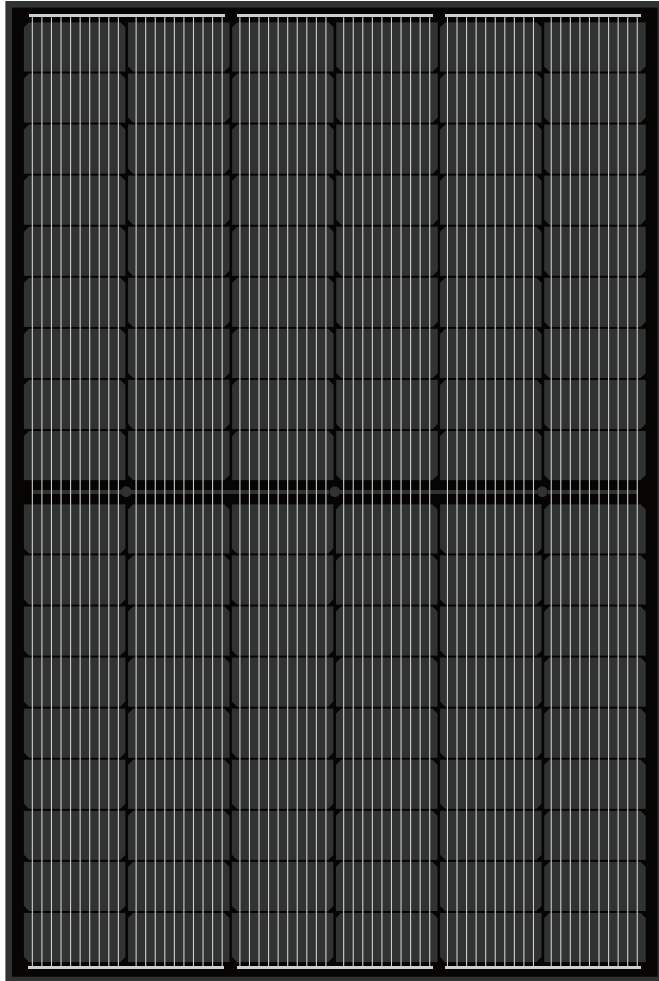

## KEY FEATURES



### High efficiency PERC

A high efficiency 182 (M10) PERC solar cell with 10 busbars technology to ensure the efficiency of the solar module up to 20.97% and stable operation.



### 0-5W tolerance

0- 5W positive power tolerance.



### Excellent performance in low light

More power output in low light conditions - through advanced glass and solar cells.



### Wind/Snow load

Wind load 2400 pa, snow load 5400 pa.



### Pid Free

Excellent Anti-PID performance, minimized degradation of power.



### Resistance against extreme environmental conditions

High Salt Mist and Ammonia resistance certified by TUV.

## LINEAR PERFORMANCE WARRANTY

12 years product warranty. 30 years linear power warranty.

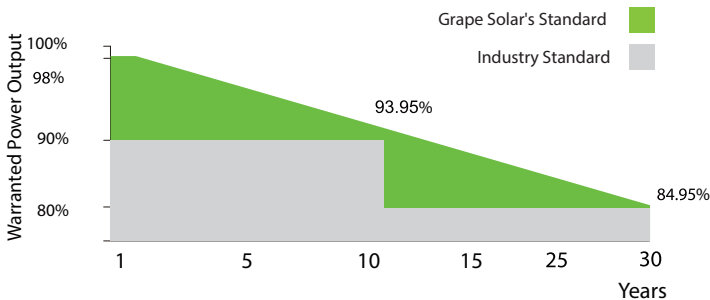

## MANAGEMENT SYSTEM CERTIFICATES

ISO 9001:2015/QUALITY MANAGEMENT SYSTEM  
ISO 14001:2015/STANDARDS FOR ENVIRONMENTAL MANAGEMENT SYSTEM

## PRODUCT CERTIFICATES

IEC 61215/IEC 61730:VDE/CE/CEC AU  
UL 61730: CSA



# SPECIFICATIONS

Module type	GS-390-54MH-M10		GS-395-54MH-M10		GS-400-54MH-M10		GS-405-54MH-M10		GS-410-54MH-M10	
	STC	(NOCT)	STC	(NOCT)	STC	(NOCT)	STC	(NOCT)	STC	(NOCT)
Maximum power(Pmax)	390Wp	292Wp	395Wp	295Wp	400Wp	299Wp	405Wp	303Wp	410Wp	306Wp
Maximum power voltage(Vmp)	30.5V	28.3V	30.7V	28.5V	30.9V	28.7V	31.1V	28.9V	31.3V	29.1V
Maximum power current (Imp)	12.79A	10.29A	12.87A	10.35A	12.95A	10.41A	13.03A	10.47A	13.10A	10.53A
Open-circuit voltage( Voc)	36.7V	34.3V	36.9V	34.5V	37.1V	34.7V	37.3V	34.8V	37.5V	35.0V
Short-circuit current(Isc)	13.56A	10.95A	13.63A	11.01A	13.70A	11.06A	13.77A	11.12A	13.84A	11.18A
Module efficiency STC (%)	19.95%		20.20%		20.46%		20.72%		20.97%	
Operating temperature(°C)	-40°C ~ 85°C									
Maximum system voltage	1500 (IEC&UL)									
Maximum series fuse rating	25A									
Sorting power tolerance	0 ~ +3%									
Temperature coefficients of Pmax	-0.35%/°C									
Temperature coefficients of Voc	-0.29%/°C									
Temperature coefficients of Isc	+0.05%/°C									
Nominal operating cell temperature(NOCT)	44 ± 2°C									

## ENGINEERING DRAWING

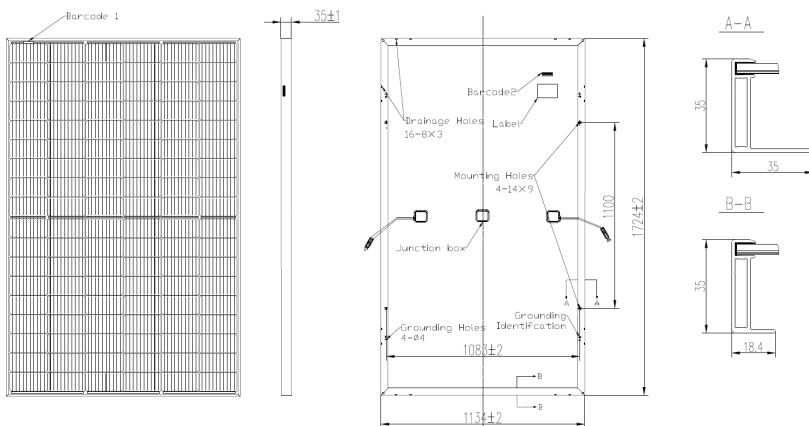

## MATERIAL CHARACTERISTICS

Number of cell	108 (6 * 18)
Dimensions	1724*1134*35mm 67.87*44.65*1.38in
Weight	20.7+/-1kg
Front glass	3.2mm, anti-reflection Coating, high transmission, low iron, tempered glass
Frame	Anodized aluminium alloy

Junction box IP68 rated 3 Diodes

Output cables 12 awg, length: 350-1200 mm (13.78-47.24 inch) or Customized length

Connectors MC4-Compatible or Customized

## PACKAGING CONFIGURATION

40HQ 806

## PV MODULE IV CURVES

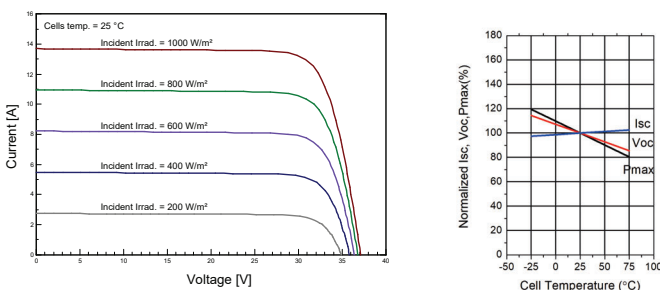

Electrical performance & temperature dependence  
Current-voltage & power-voltage curves (400W)  
temperature dependence of Isc, Voc, Pmax

JUNE 2020|ALL RIGHTS RESERVED|PV MODULE PRODUCT DATASHEET GS-410-54MH-M10

Grape Solar Inc.  
2635 West 7th Place, Eugene, Oregon 97402 USA  
Tel: 1-541-349-9000; Fax: 1-541-343-9000 | info@grapesolar.com | www.grapesolar.com